

ELECTRICAL AND PNEUMATIC OPERATION UPON REQUEST

FULL B. H (APPROX.)
RED. B. H1 (APPROX.)

LIST OF MATERIALS

POS.	PART NAME	MATERIAL
5	BODY	A105
10	ADAPTOR	A105
15	BALL	A105 + ENP
35	UPPER BODY BONNET	A105
60	SHaft	A479 T410
70	SEAT	PTFE
75	SEAT CARRIER	A105 + ENP
100	BALL GUIDE	A105
170	SUPPORT FLANGE	A105
190	UPPER BEARING	DU-DRY
200	UPPER BEARING BALL GUIDE	DU-DRY
238	SUPPORT FLANGE GASKET	GRAPHITE
287	UPPER BONNET GASKET	GRAPHITE
315	UPPER BONNET "O" RING	VITON
325	SEAT CARRIER "O" RING	VITON
335	STEM "O" RING	VITON
353	HANDLE BOLT	CARBON STEEL
421	SUPPORT FLANGE BOLT	A193 B7
445	UPPER BONNET BOLT	CARBON STEEL
558	THRUST BEARING	DU-DRY
565	WASHER	CARBON STEEL
580	SEAT SPRING	INCONEL X750
610	HANDLE PLATE	CARBON STEEL
620	HANDLE	CARBON STEEL

OTHERS MATERIALS AVAILABLE UPON REQUEST

SIZE	A		ØB	ØC	H	H1	L	WEIGHT	
	BW-RF	RTU						FULL BORE	REDUCED BORE
34"	1930	—	832	781	1510	1415	GEAR	8700	7650
36"	2083	—	876	832	1550	1510	GEAR	10800	8400
40"	2337	—	978	876	1620	1550	GEAR	13900	9900
42"	2388	—	1022	978	1675	1620	GEAR	15400	11200

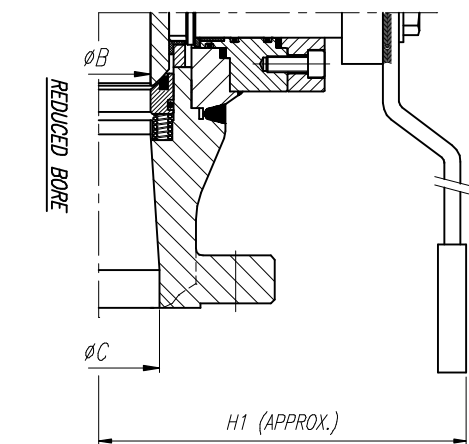

SIZE	A		ØB	ØC	H	H1	L	WEIGHT	
	BW-RF	RTU						FULL BORE	REDUCED BORE
2"	292	295	51	—	150	—	380	31	—
3"	356	359	76	51	180	150	480	43	36
4"	432	435	102	76	205	180	580	90	65
6"	559	562	152	102	475	205	GEAR	270	145
8"	660	664	203	152	595	475	GEAR	450	290
10"	787	791	254	203	790	595	GEAR	720	500
12"	838	841	305	254	825	790	GEAR	1000	760
14"	889	892	337	305	890	825	GEAR	1080	890
16"	991	994	387	337	960	890	GEAR	1515	1300
18"	1092	1095	438	387	1010	960	GEAR	1990	1700
20"	1194	1200	489	438	1075	1010	GEAR	2620	2200
24"	1397	1406	590	489	1190	1075	GEAR	4650	3600
26"	1448	—	635	590	1245	1190	GEAR	5080	4200
28"	1549	—	686	635	1295	1245	GEAR	6000	5100
30"	1651	—	737	686	1360	1295	GEAR	6850	5800
32"	1778	—	781	737	1415	1360	GEAR	7800	6850

RINGCO VALVULAS
 GENERAL ASSEMBLY & LIST OF MATERIALS
 BALL VALVE 600#
 BR06S1
 Date: 20/12/03
 Date: 20/12/03
 Sheet: 1 of 1
 Scale: AS
 Size: A3
 Dwg No: BR06S1
 REV: 0