

ELECTRICAL AND PNEUMATIC OPERATION UPON REQUEST

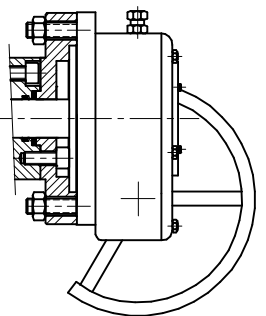

LIST OF MATERIALS		
POS.	PART NAME	MATERIAL
5	BODY	A105
10	ADAPTOR	A105
15	BALL	A105 + ENP
60	SHAFT	A479 T410
70	SEAT	PTFE
170	SUPPORT FLANGE	A105
240	BODY ADAPTOR GASKET	GRAPHITE
241	STEM GASKET	GRAPHITE
288	UPPER FLANGE GASKET	GRAPHITE
295	BODY ADAPTOR O-RING	VITON
335	STEM "O" RING	VITON
353	HANDLE BOLT	A193 B7
385	BODY ADAPTOR STUD	A193 B7
390	BODY ADAPTOR STUD NUT	A194 2H
421	SUPPORT FLANGE BOLT	A193 B7
610	HANDLE PLATE	CARBON STEEL
620	HANDLE	CARBON STEEL

OTHERS MATERIALS AVAILABLE UPON REQUEST

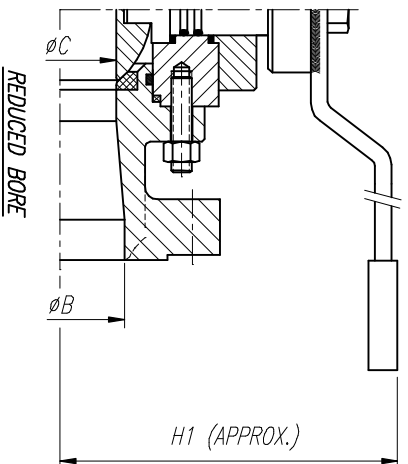

SIZE	A				ØB	ØC	H	H1	L	WEIGHT
	BW	RF	RTU	RTU						
1/2"	216	216	216	11	11	73	—	150	11	
3/4"	229	229	229	20	11	75	73	180	17	
1"	254	254	254	25	20	78	75	180	20	
1 1/2"	305	305	305	38	25	100	78	280	33	
2"	368	368	371	51	38	136	100	280	50	
3"	381	381	384	76	51	165	136	280	78	

REV	Description	Detail	Drawn	Date	Appr	Date

		GENERAL ASSEMBLY & LIST OF MATERIALS	
Drawn	JLO	Date	20/12/03
Appr		Sheet	
Title: FLOATING BALL VALVE 900#		Scale	A3
Description: FLOATING BALL VALVE 900#		Size	A3
Gen Tol ± 0.4		Drawg No	BR09FA1
REV	0	Date	